

Actiflex II Single Monitor Arm

Product Code: UP-A II Single



*Desk pole mount articulating single monitor arm
with cable management and height adjustment*

Features:

- Spring articulated pole mounted arm "floats" monitor above desktop
- Fingertip adjustment of depth and height
- Desk-clamp or through-mount included
- Easy above desk installation
- Fully adjustable: 360° rotate, 180° tilt and swivel
- 75mm/100mm VESA mounting pattern compatible
- Quick release VESA brackets for easy monitor mounting
- Integrated cable management
- Supports up to 8kg per monitor
- Suitable for most LCD/LED monitors up to 32" (813mm) size

Actiflex II Single Monitor Arm

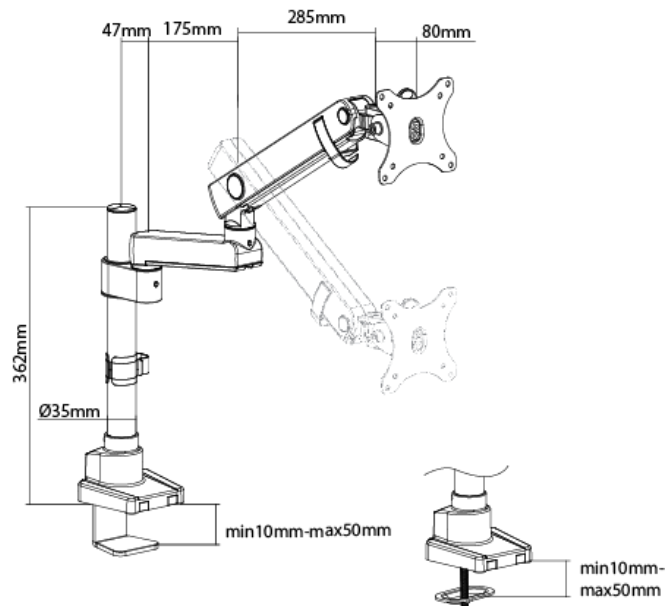

Capabilities

| | |
|-------------------------|--|
| Height range | 110mm - 600mm (centre VESA) |
| Adjustable height range | 490mm |
| Pole Height | 360mm |
| Pole Diameter | 34mm |
| Horizontal reach range | 0 - 580mm (centre VESA) |
| Screen Size | 17"-32" |
| Monitor tilt | 0 - 180 degrees both vertical and horizontal |
| Monitor pivot | Landscape and portrait – 360 degrees |
| Monitor compatibility | VESA 75mm and 100mm |
| Mounting options | Desk clamp or Grommet mount |
| Monitor weight | 0 - 8kg per monitor |