

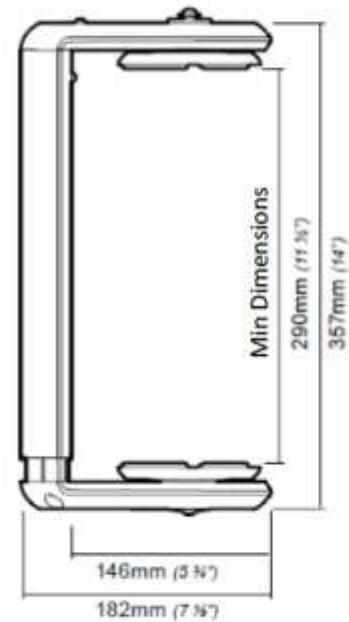

TECHNICAL SPECIFICATION SHEET

PRODUCT NAME: Jaw
PRODUCT CODE: CPU/013
Doc Rev 1, 30.07.2015, CF

Min / Max CPU Dimensions

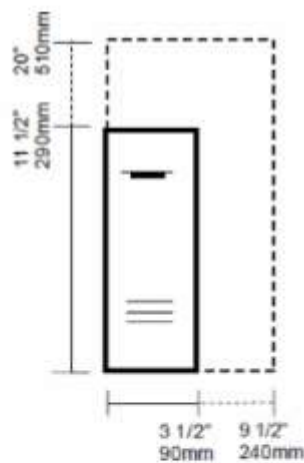

*Note that dimensions provided are measured in mm

*Note additional fixing bracket is required
e.g. UNI/ROT, UNI/SR350, UNI/SR520

KEY FEATURES

- Easy to assemble and install
- Durable and secure storage
- Fully adjustable to accommodate various CPU sizes
- Stylish design that appears to float under the desk

Product Classification	CPU holders
Max load	25kg (55.1 lbs)
Build level	M
Recycled content	34%
Total product recyclable	100%

Adjustable CPU cradle

JAW.
CPU-013

MAX
25kg/55.1lb

List of parts:
 JAW CPU holder
 M6 bolt
 shoulder washer
 washer
 clamping disc
 M6 nut
 rubber pad
 5mm Allen key

510
290
90 240
(mm)
Min/Max
CPU Dimensions

Mounting options

CPU holder mounting with rotating function
UNI/ROT

CPU holder fixing Slide & Rotate
UNI/SR350

CPU holder fixing Slide & Rotate
UNI/SR

rubber stoppers
slider
rail
washer screw

M6 nyloc nut*
nylon washer*
washer*
bolt*

DO NOT throw away rubber stoppers
Parts marked (*) not required for JAW installation

Assemble the JAW
Fit the slider plate

1 Adjust clamping disc with top and bottom screw in centre

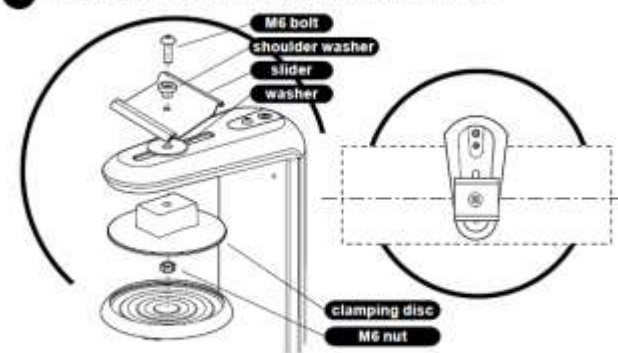

Fix your CPU

2 Unwind JAW to open up then tighten on CPU

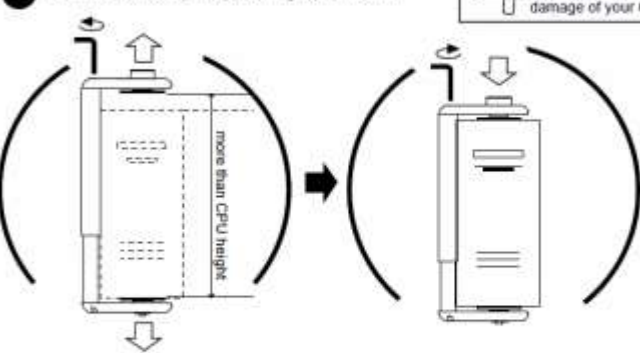

NOTE
The use of excessive force when tightening may result in the damage of your CPU

Mount to furniture
Preparation

3 Make sure the CPU has enough space to rotate



Mounting the bracket to the underside of the desk

4 Screw your chosen mount rail securely to the underside of the desk using screws provided

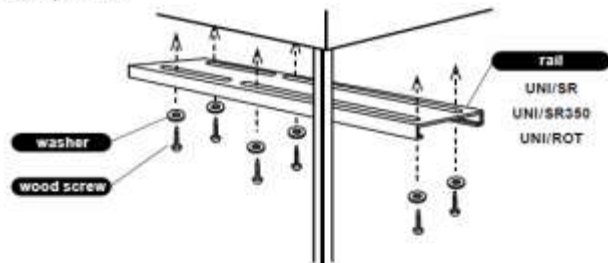

Insert the JAW

5 Slide the JAW into the rails then insert the rubber stopper(s)

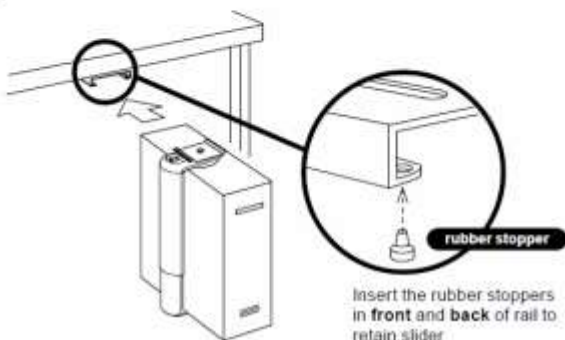

WARNING

- Ensure desk is suitable to take the weight of the CPU holder and CPU.
- Do not use this product for any purpose other than that for which it was designed.
- Hold the CPU tightly when making adjustments.
- Care should be taken to avoid trapping fingers.
- Do not dismantle or modify the CPU cradle.
- Supported weight must not exceed 25kg (55lb) per cradle.

MAINTENANCE and INSPECTION

- Ensure all screws are tightened and occasionally adjust if needed.
- Clean with a damp cloth, NO solvents.

DISCLAIMERS

- The use of power tools, lever bars or excessive force during the installation, or reconfiguration of the product will invalidate your guarantee.
- Failure to observe the recommendations in the use, and configuration of these products may affect your guarantee.

Issue no 5 MAR.2006 www.cbsproducts.co.uk